

The Chestnut

4 bedroom home

Ground floor	metres	feet / inches
Kitchen	3.08 x 2.87	10' 1" x 9' 5"
Dining area	3.78 x 3.03	12' 5" x 9' 11"
Sitting room	4.92 x 3.40	16' 2" x 11' 2"
Study	3.40 x 1.86	11' 2" x 6' 1"

First floor

Bedroom 1	3.21 x 3.06	10' 6" x 10' 0"
Bedroom 2	3.44 x 3.34	11' 3" x 10' 11"
Bedroom 3	3.20 x 2.32	10' 6" x 7' 7"
Bedroom 4	3.40 x 2.34	11' 2" x 7' 8"

The Chestnut | X413 P5 vt MWTC |

This floorplan has been produced for illustrative purposes only. Room sizes shown are between arrow points as indicated on plan. The dimensions have tolerances of + or -50mm and should not be used other than for general guidance. If specific dimensions are required, enquiries should be made to the sales advisor.

* Windows apply to plot 55 only. Please see sales advisor for further details.

ovn	oven	ffzr	fridge freezer
h	hob	w	wardrobe
ds	dishwasher space	cup'd	cupboard
ws	washing machine space	< >	measuring points

Please refer to the sales advisor for specific plot details as the illustrations shown are computer generated impressions of how the property may look so are indicative only. External details or finishes may vary on individual plots and homes may be built in either detached or attached styles depending on the development layout. Exact specifications, window styles and whether a property is left or right handed may differ from plot to plot.

The floorplans shown are not to scale. Measurements are based on the original drawings. Slight variations may occur during construction.

Produced by the Bovis Homes Graphic Design Department.

When you have finished with this leaflet please recycle it.

MWTC GD51540 / 08.19

First floor

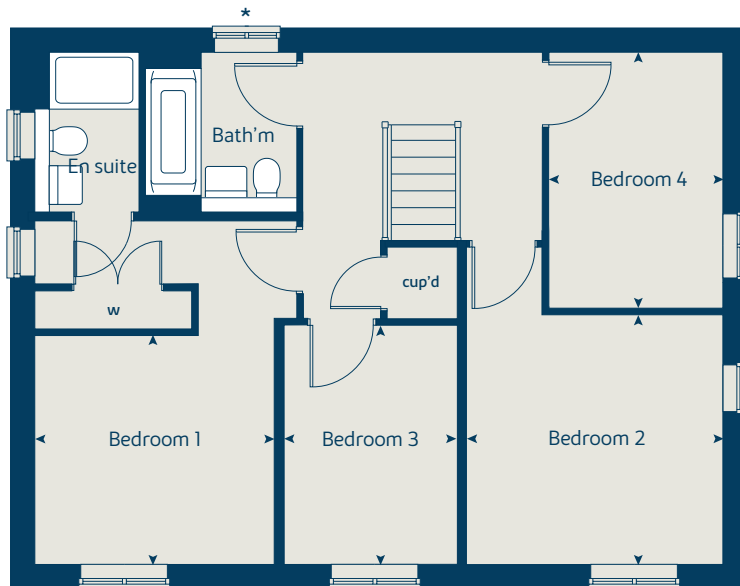

Ground floor

